

Soils Map

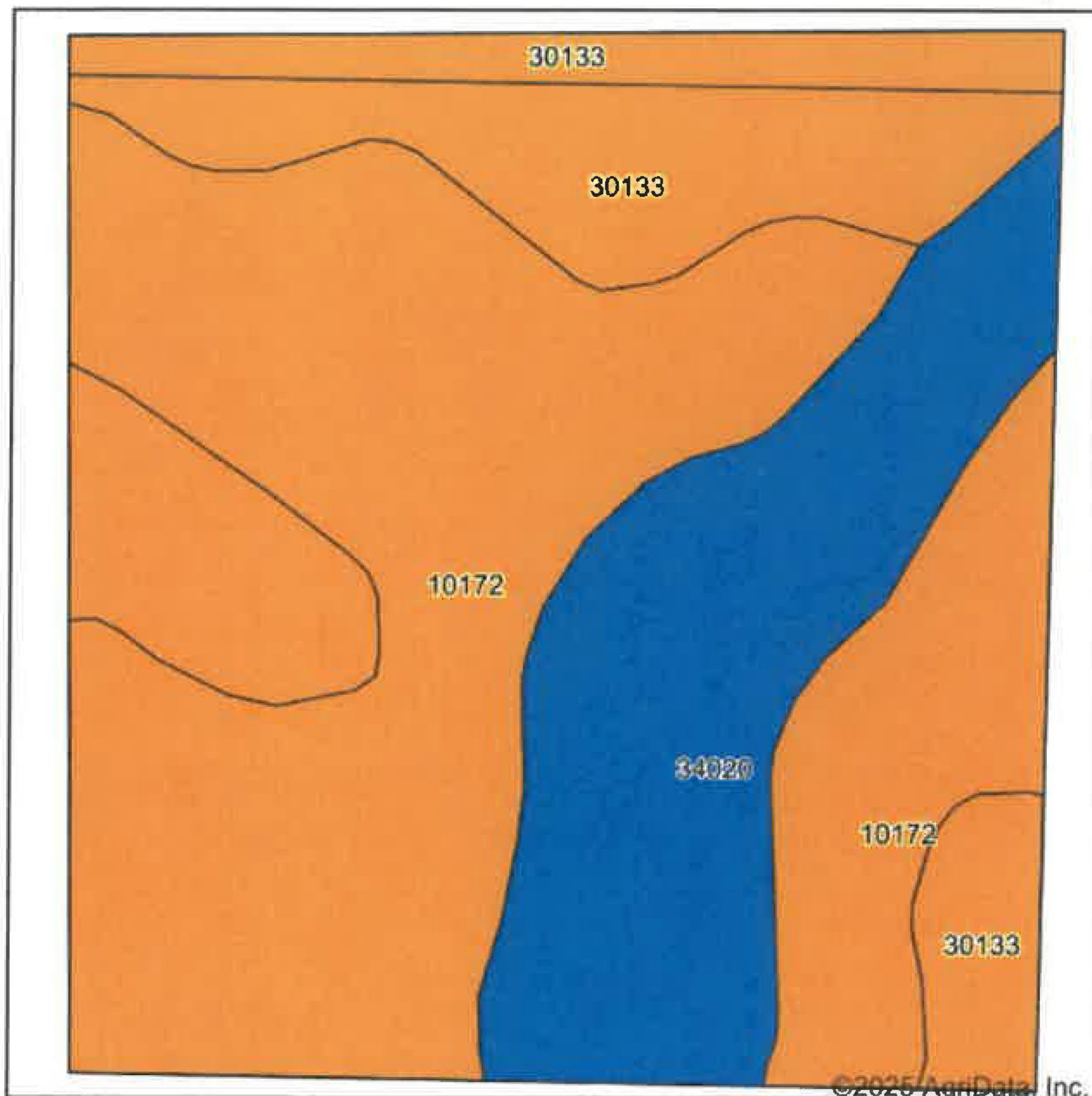

Soils data provided by USDA and NRCS.

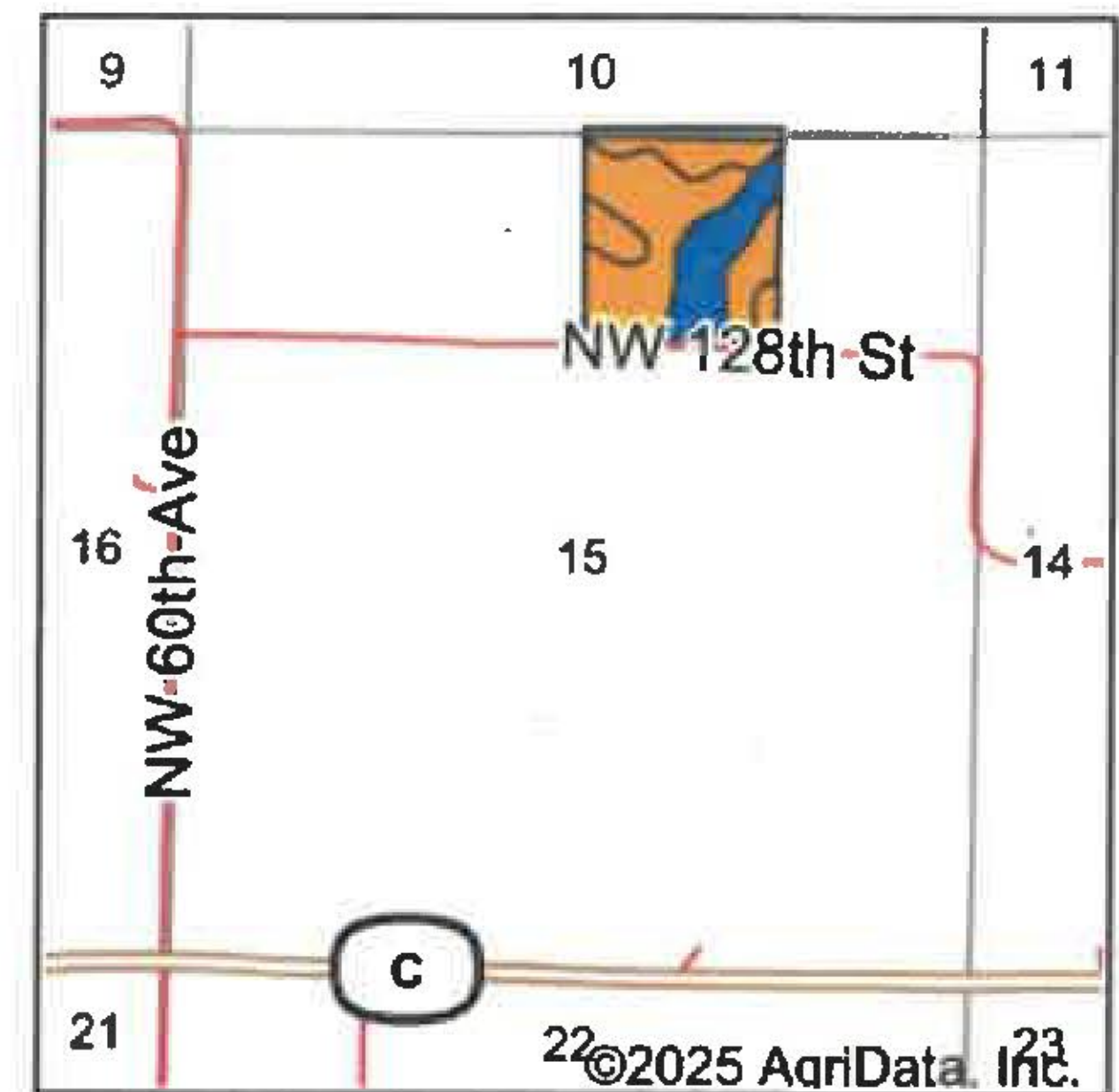

State: **Missouri**
 County: **Grundy**
 Location: **15-63N-25W**
 Township: **Washington**
 Acres: **38.31**
 Date: **4/15/2025**

United Country
 NELSON REAL ESTATE

Maps Provided By:

surety
 CUSTOMER'S ONLINE MAPPING
 © AgriData, Inc. 2023 www.AgriDataInc.com



Area Symbol: MO079, Soil Area Version: 28					
Area Symbol: MO129, Soil Area Version: 26					
Code	Soil Description	Acres	Percent of field	Non-Irr Class Legend	Non-Irr Class *c
10172	Shelby clay loam, 9 to 14 percent slopes, moderately eroded	19.87	51.8%		IIle
34020	Colo silty clay loam, drainageway, 2 to 5 percent slopes, frequently flooded	8.58	22.4%		IIw
30133	Lamoni clay loam, 5 to 9 percent slopes, eroded	7.99	20.9%		IIle
30133	Lamoni clay loam, 5 to 9 percent slopes, eroded	1.87	4.9%		IIle
Weighted Average					2.78

*c: Using Capabilities Class Dominant Condition Aggregation Method